

DIMENSIONS

MILLIMETERS(INCHES)

MFC Series Suction Filters(Strainer)   
 MFCS 304 Stainless Submerged Suction Filters 100 Mesh



Threaded Connection: PT, BSP and NPT.  
 Port Size from 1/4" to 4"  
 Flow Rate: 25~1300 lpm  
 Max. working temperature :90° C (194° F)  
 Protect pump and system components

■ Ratings

Series	φA PT (Rc)	B mm (in)	C mm (in)	D mm (in)	E mm (in)	Flow lpm	Filtration Mesh	Weight kg(lb)	
MFC MFCS	02	1/4" (.86)	22 (3.11)	79 (3.11)	90 (3.54)	25	100	.11 (.24)	
	03	3/8" (.86)	22 (3.11)	79 (3.11)	90 (3.54)			30	.11 (.24)
	03	3/8" (.86)	35 (1.37)	46 (1.81)	62 (2.44)	18	150	.1 (.22)	
	04	1/2" (1.10)	28 (4.09)	115 (4.52)				50	.15 (.33)
	04	1/2" (1.10)	28 (2.51)	75 (2.95)	90	30	150	.12 (.26)	
	06	3/4" (1.33)	34 (6.41)	175 (6.88)				90	.18 (.39)
	06	3/4" (1.33)	34 (2.51)	75 (2.95)	83 (3.26)	45	150	.12 (.26)	
	08	1" (1.81)	46 (5.11)	145 (5.70)				160	.35 (.77)
	10	1 1/4" (2.04)	52 (5.19)	132 (5.19)	145 (5.70)	102 (4.01)	280	.5 (1.11)	
	12	1 1/2" (2.40)	61 (7.55)	192 (8.07)	205 (8.07)			420	.8 (1.77)
	MFC	16	2" (2.83)	72 (8.18)	208 (8.18)	225 (8.85)	120 (4.72)	550	1.0 (2.22)
		16	2" (2.83)	72 (10.2)	280 (11.0)	140 (5.51)			700
		20	2 1/2" (3.42)	87 (12.0)	307 (12.9)	330 (12.9)	147 (5.78)	850	1.3 (2.88)
		24	3" (4.13)	105 (12.0)	307 (12.9)	330 (12.9)			1000
24		3" (5.74)	146 (10.2)	260 (10.8)	275 (10.8)	208 (8.18)	1100	3.15 (6.99)	
32		4" (5.74)	146 (14.3)	380 (14.9)	208 (8.18)			1300	3.0 (6.66)

■ Ordering Code

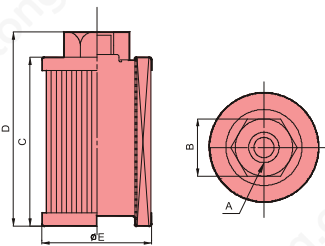
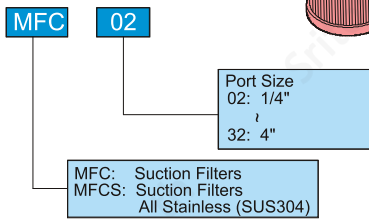

IDN Series Suction Filters (Strainer)150 Mesh 

Threaded Connection: PT, BSP and NPT.  
 Port Size from 1/2" to 3"  
 Flow Rate: 35~600 lpm  
 Max. working temperature :90° C (194° F)  
 Protect pump and system components

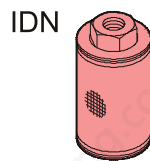

■ Ordering Code

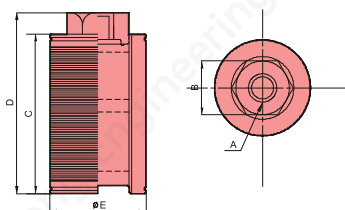
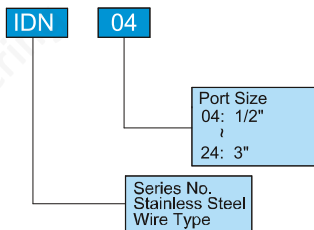

■ Ratings

Series	φA PT (Rc)	B mm (in)	C mm (in)	D mm (in)	E mm (in)	Flow lpm	Filtration Mesh	Weight kg(lb)
IDN-04	1/2"	28 (1.10)	156 (6.14)	167 (6.57)	61 (2.40)	35	150	.24 (.53)
IDN-06	3/4"	34 (1.33)	156 (6.14)	171 (6.73)	61 (2.40)	46		.26 (.57)
IDN-08M	1"	46 (5.59)	142 (5.59)	158 (6.22)	82 (3.22)	90		.39 (.86)
		193 (7.59)	208 (8.18)	.45 (.99)				
IDN-10	1 1/4"	52 (2.04)	213 (8.38)	227 (8.93)	102 (4.01)	150		.73 (1.62)
IDN-12	1 1/2"	61 (2.40)	232 (9.13)	246 (9.68)	120 (4.72)	205		.97 (2.15)
IDN-16	2"	72 (2.83)	314 (12.3)	331 (13.0)	120 (4.72)	320		1.24 (2.75)
IDN-20	2 1/2"	87 (3.42)	417 (16.4)	439 (17.2)	146 (5.74)	550		2.50 (5.55)
IDN-24	3"	105 (4.13)	417 (16.4)	439 (17.2)	146 (5.74)	600		2.55 (5.66)